



# Save time and water with single-insertion barrel cleaning

## Alfa Laval Gamajet BB

### Application

With a single insertion of the Alfa Laval Gamajet BB, barrels and 208.2 l (55 gal) drums are cleaned in only 2-3 minutes while using only 30-45 l (8-12 gal) of water. This device offers high-performance cleaning combined with maximum durability. A heavy-duty stainless steel gear train remains outside the barrel or drum during cleaning, ensuring a long service life. The Alfa Laval Gamajet BB ultimately saves companies a substantial amount of time, water, and money.

### Working principle

The Alfa Laval Gamajet BB tank cleaning device combines pressure and flow to create high impact cleaning jets. Cleaning occurs at the point at which the concentrated stream impacts the surface. It is this impact and the tangential force that radiates from that point which blasts contaminants from the surface, scouring the tank interior. In conjunction with this impact, the device is engineered to rotate in a precise, repeatable and reliable, 360° pattern. This full-coverage, global indexing pattern ensures the entire tank interior is cleaned, every time.



### TECHNICAL DATA

Lubricant . . . . . Food grade  
 Max. throw length . . . . . 2.5 m (8 ft.)

### Pressure

Working pressure . . . . . 5.5 - 83 bar (80 - 1,200 PSI)  
 Recommended pressure . . . . . 5.5 - 55 bar (80 - 800 PSI)

### Cleaning Pattern

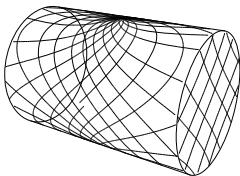

First Cycle

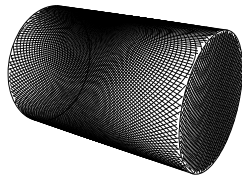

Full Pattern

The above drawings show the cleaning pattern achieved on a cylindrical horizontal vessel. The difference between the first cycle and the full pattern represents the number of additional cycles available to increase the density of the cleaning.

### Certificate

2.1 material certificate

### PHYSICAL DATA

#### Materials

1.4404 (316L), PPS, EPDM, PTFE (FKM and FFKM available)

#### Temperature

Max. working temperature . . . . . 95°C (203°F)  
 Max. ambient temperature . . . . . 140°C (284°F)

#### Weight

. . . . . 4.5 kg (10 lbs.)

#### Connections

Standard thread . . . . . 3/4" NPT  
 Available option . . . . . 3/4" NPT, 3/4" BSP

#### Options

Electronic rotation sensor to verify 3D coverage.

#### Caution

Do not use for gas evacuation or air dispersion.



Disclaimer: Information in this product data leaflet is intended for general guidance purposes. Specific data for device selection and sizing is available upon request.

**Flow Rate**

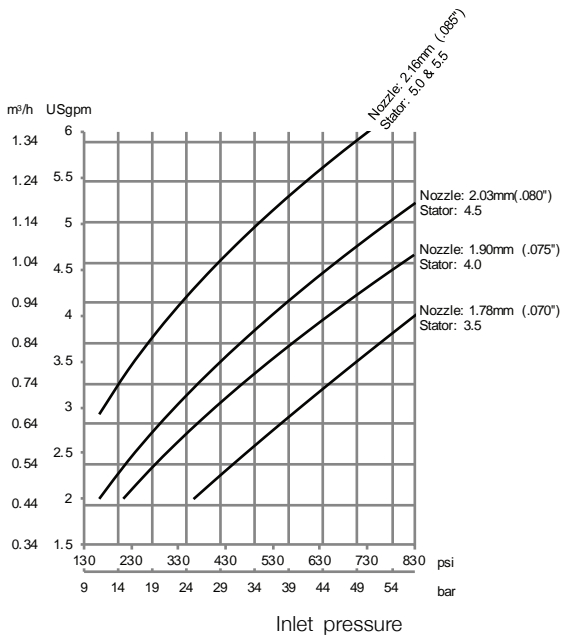

**Impact Throw Length**

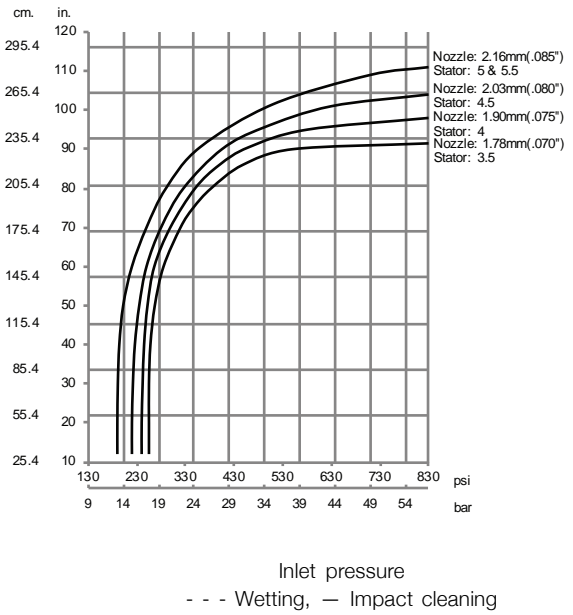

**Cleaning Time**

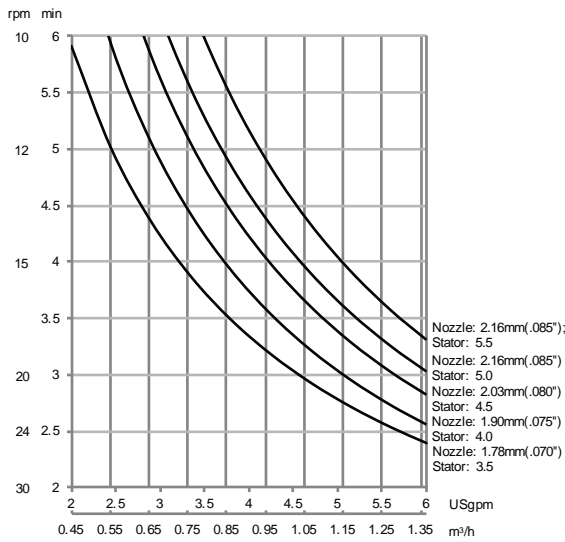

**Dimensions**

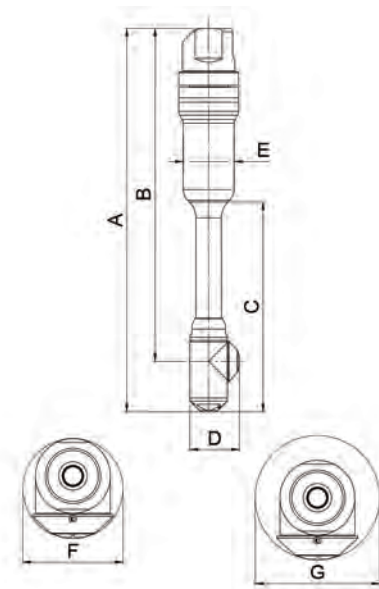

**Dimensions**

	A	B	C	D	E	F	G
mm	325	282	178	42	44	43	52
in	12.79	11.1	6.99	1.66	1.7	1.67	2.05

### Standard Design

The choice of nozzle diameters can optimize jet impact length and flow rate at the desired pressure. As standard documentation, the Alfa Laval Gamajet BB can be supplied with a “Declaration of Conformity” for material specifications.

### TRAX simulation tool

TRAX is a unique software that simulates how the Alfa Laval Gamajet BB performs in a specific tank or vessel. The simulation gives information on wetting intensity, pattern mesh width and cleaning jet velocity. This information is used to determine the best location of the tank cleaning device and the correct combination of flow, time, and pressure to implement.

A TRAX demo containing different cleaning simulations covering a variety of applications can be used as a reference and documentation for tank cleaning applications. The TRAX demo is free and available upon request.

### Wetting Intensity

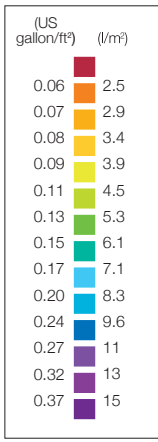

TD 523-208

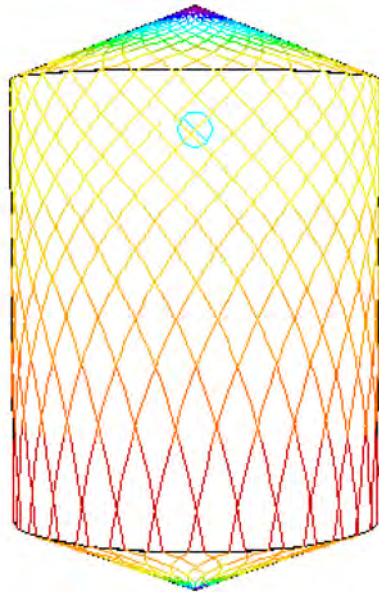

D2.5m (100”), H4.1m (160”), 2xØ2.03mm (2xØ.08”) Time = 1 min.

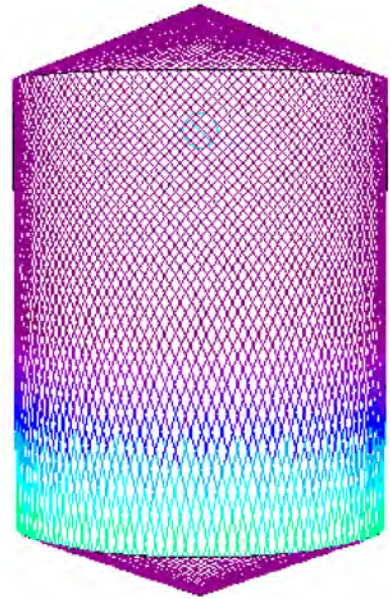

D2.5m (100”), H4.1m (160”), 2xØ2.03mm (2xØ.08”) Time = 4 min.

Alfa Laval reserves the right to change specifications without prior notification. ALFA LAVAL is a trademark registered and owned by Alfa Laval Corporate AB.

ESE03002EN 0515

© Alfa Laval

---

**How to contact Alfa Laval**

Contact details for all countries are continually updated on our website. Please visit [www.alfalaval.com](http://www.alfalaval.com) to access the information direct.